

# Trouble Shooting

- **Will Not Start**  
Check the power switch and power cord connection.
- **No Inlet Flow**  
Check system Fluid level and suction hose connection to reservoir.  
Check for suction leaks.
- **No Outlet Flow**  
Check pressure gauges for above normal pressure. Cause may be dirty filters.  
Check for inlet flow.  
Wait 10-15 seconds for filters to fill.
- **Intermittent Oil Flow and Aeration:**  
Check the system fluid level. Check suction line for leaks.
- **Leaking between the head gasket and the top cap:**  
Tighten the Filter to the head.  
Still Leaking – Order Gasket 17E-AD-GASKET and replace
- **Leaking between the top cap and the body**  
Tighten the filter body to the top cap.  
Still Leaking – Order “O” RING 4010-245V7 and replace.
- **Leaking between the body and the bottom cap.**  
Order bottom assembly CFB-15034-ASSY-LE and replace.
- **Drain plug leaking**  
Wrap with Teflon plumbers tape and re-install.  
Still Leaking – If cross threaded, Order bottom assembly CFB-15034-ASSY-LE

Chase Drum Topper					Example Part Number											
					A	B	C		D	E						
					CDT	3	-	10MA	-	3M	V	-	N	N		
Section A																
Filter Series		Drum Topper			CDT	CDT										
Section B																
Pump / Motor		3.5 GPM / .25 hp electric, 115 vac, 60 hz, 1725 rpms, 5 amps			10	3										
Section C																
Material		Micron/Nom	Micron/Abs													
Inlet Element	Cellulose	3		3C	3C											
	Microglass		3	3M	3M											
	Cellulose	10		10C	10C											
	Cellulose Water Abs.	10		10CA	10CA											
	Microglass		10	10M	10M											
	Microglass Water Absorbing		10	10MA	10MA											
	Cellulose	25		25C	25C											
	Microglass		25	25M	25M											
	SS Mesh	40	75	100S	100S											
Section D																
Material		Micron/Nom	Micron/Abs													
Outlet Element	Cellulose	3		3C	3C											
	Microglass		3	3M	3M											
	Cellulose	10		10C	10C											
	Cellulose Water Abs.	10		10CA	10CA											
	Microglass		10	10M	10M											
	Microglass Water Absorbing		10	10MA	10MA											
	Cellulose	25		25C	25C											
	Microglass		25	25M	25M											
	SS Mesh	40	75	100S	100S											
Section E																
Material																
O-Ring	Buna				N						N					
Material	Viton				V						V					
	EPR				E						E					
Section F																
Bypass																
Manual Bypass	Bypass				B									B		
	No Bypass				N									N		
Section G																
Ports																
Sample Ports	Standard				S									S		
	None				N									N		

Don't see the options you need? Contact our Technical Support team at (757) 327-6036 or [info@chasefiltercompany.com](mailto:info@chasefiltercompany.com)



## FLUID HANDLING | Drum Topper



Convenient, portable filtration in a compact design that you can carry wherever you need to go.

# The Overview

## THE DRUM TOPPER

### Where It's Used

- Decontaminating systems
- Flushing new or repaired systems
- Dispensing new oil
- Pre-filtering new oil
- Evacuating used oil
- Topping off reservoirs
- Collecting oil samples for analysis

## WHAT IS STANDARD?

- Automatic pressure relief valve
- Dual-stage filtration
- 6' hose assemblies with various hose-end connections
- Industrial powder-coated paint
- One-year warranty

## WHAT CAN I CUSTOMIZE?

- Flow rates
- Filter bypass
- Sample valves
- Color
- Hose-end connection sizes and types
- Micron rating of filters

**Please Note: Our standard motors are 115/230 VAC, single phase, 60 Hz**

## PERFORMANCE

For filtering mineral-based industrial oils and most synthetic oils with a maximum operating viscosity range of ISO 10-460 (2000ssu/431cSt) at 100°F/38°C within ambient temperature ranges of -8°F to 104°F (-22°C to 40°C)

### Materials

- Frame: Aluminum
- Paint: Industrial powder coat
- Filter Heads: Aluminum
- Fittings: Zinc-plated steel and/or brass
- Pumps: Aluminum/steel
- Hoses: Clear PVC with steel wire
- Gaskets: Buna-N

### Filter Indicators:

- Filter indicator pops at 22psid (1.55bar) as warning that filter elements need to be replaced

### Pump Relief:

- Opens at 65psi (5.49bar)

### Weight:

- Approximately 45-55 lbs/20.4-24.9Kg (will vary depending on options selected)

### Dimensions:

- 24.5" L x 13.5W x 15.4" H

## Call CHASE for the Following Needs:

- Explosion-proof
- Wands
- Threaded end connectors
- Hydraulic hoses
- Viton® Gaskets
- High-viscosity push button sample valves

# The Specs

## By the Numbers

Item No.	Description	Qty.
1	Post-Filter Sample Valve	1
2	Filter Element	2
3	Filter Head	2
4	Manual Fitter Bypass Valve	1
5	Pump Relief-65psi	1
6	10' Power Cord	1
7	Motor	1
8	W Inlet Hose	1
9	Quick Connect	1
10	Gear Pump	1
11	Pre-Filter Sample Valve	1
12	1/2 Outlet Hose	1

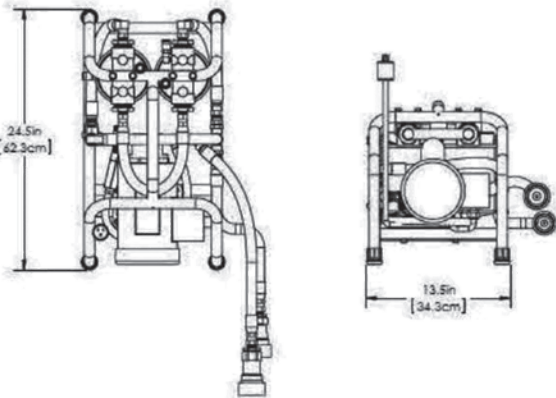
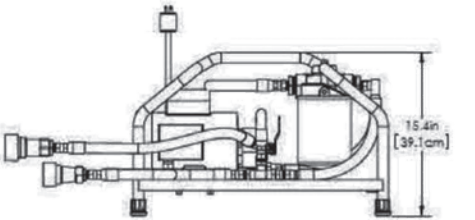
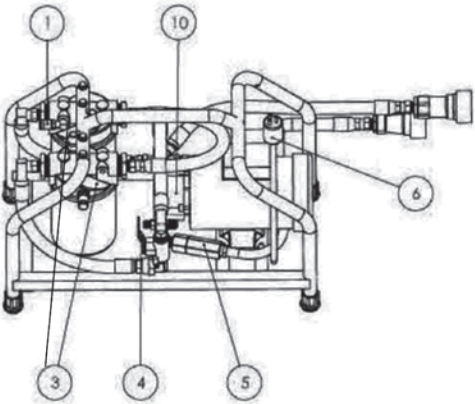
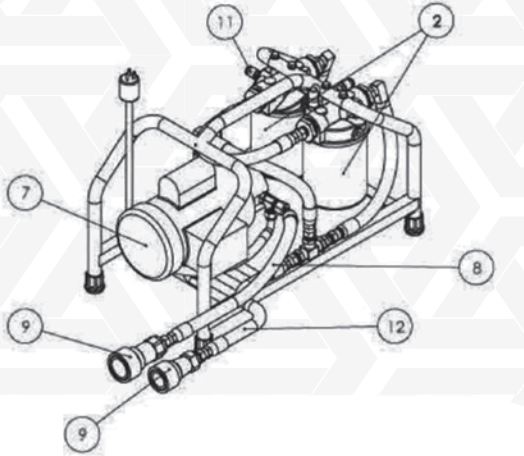

Don't see the options you need? Contact our Technical Support team at (757) 327-6036 or [info@chasefiltercompany.com](mailto:info@chasefiltercompany.com)

For ordering information, please see insert or contact us at (757) 327-6036.