

Trouble Shooting

- **Will Not Start**

Check the power switch and power cord connection.

- **No Inlet Flow**

Check system Fluid level and suction hose connection to reservoir.

Check for suction leaks.

- **No Outlet Flow**

Check pressure gauges for above normal pressure. Cause may be dirty filters.

Check for inlet flow.

Wait 10-15 seconds for filters to fill.

- **Intermittent Oil Flow and Aeration:**

Check the system fluid level. Check suction line for leaks.

- **Leaking between the head gasket and the top cap:**

Tighten the Filter to the head.

Still Leaking – Order Gasket 17E-AD-GASKET and replace

- **Leaking between the top cap and the body**

Tighten the filter body to the top cap.

Still Leaking – Order “O” RING 4010-245V7 and replace.

- **Leaking between the body and the bottom cap.**

Order bottom assembly CFB-15034-ASSY-LE and replace.

- **Drain plug leaking**

Wrap with Teflon plumbers tape and re-install.

Still Leaking – If cross threaded, Order bottom assembly CFB-15034-ASSY-LE

Chase Filter Cart					Example Part Number											
					A	B	C			D	E					
					CFC	10	-	10MA	-	3M	V	-	N	N	25	
Section A																
Filter Series		Filter Cart			CFC	CFC										
Section B																
Pump / Motor		10GPM / 1hp electric, 115 vac, 60 hz, 1725 rpms, 13 amps			10	10										
Section C		Material	Micron/Nom	Micron/Abs												
Inlet Element	Cellulose	3	3C	3C												
	Microglass	3	3M	3M												
	Cellulose	10	10C	10C												
	Cellulose Water Abs.	10	10CA	10CA												
	Microglass	10	10M	10M												
	Microglass Water Absorbing	10	10MA	10MA												
	Cellulose	25	25C	25C												
	Microglass	25	25M	25M												
	SS Mesh	40	75	100S	100S											
	Section D		Material	Micron/Nom	Micron/Abs											
Outlet Element	Cellulose	3	3C	3C												
	Microglass	3	3M	3M												
	Cellulose	10	10C	10C												
	Cellulose Water Abs.	10	10CA	10CA												
	Microglass	10	10M	10M												
	Microglass Water Absorbing	10	10MA	10MA												
	Cellulose	25	25C	25C												
	Microglass	25	25M	25M												
	SS Mesh	40	75	100S	100S											
	Section E		Material													
O-Ring	Buna	N	N													
Material	Viton	V	V													
	EPR	E	E													
Section F		Bypass														
Manual Bypass	Bypass	B	B													
	No Bypass	N	N													
Section G		Ports														
Sample Ports	Standard	S	S													
	None	N	N													
Section H		Length														
Electrical Cord	25 Foot Cord	25	25													
	50 Foot Cord	50	50													

Don't see the options you need? Contact our Technical Support team at (757) 327-6036 or info@chasefiltercompany.com



FLUID HANDLING | Filter Cart



A portable, offline filtration system that's ideal for mineral-based industrial fluids and a wide range of applications.

The Overview

THE FILTER CART

Where It's Used

- Decontaminating systems
- Flushing new or repaired systems
- Dispensing oil
- Pre-filtering new oil
- Evacuating used oil
- Topping off reservoirs
- Collecting oil samples for analysis

WHAT IS STANDARD?

- Automatic pressure relief valve
- Dual-stage filtration
- 12' hose assemblies with various quick connect options
- Pneumatic wheels for easy mobility
- Industrial powder-coated paint
- Heavy-duty cart with oil catch pan
- One-year warranty

PERFORMANCE

For filtering mineral-based industrial oils and most synthetic oils with a maximum operating viscosity range of ISOVG 680 (3000ssu/680cSt) at 100°F/38°C within ambient temperature ranges of -15°F to 150°F (-26C to 66°C)

Materials

- Frame: Carbon Steel
- Paint: Industrial powder coat
- Filter Heads: Aluminum
- Fittings: Zinc-plated steel and/or brass
- Pumps: Aluminum/steel
- Hoses: Clear PVC with steel wire or hydraulic hose
- Gaskets: Buna-N

Filter Indicators:

- Filter indicator pops at 22psid (1.55bar) as warning that filter elements need to be replaced

Pump Relief:

- Opens at 65psi

Weight:

- Approximately 100-150 lbs.
(will vary depending on options selected)

Dimensions:

- 18.8" L x 21.5" W x 46.4" H

Call CHASE for the Following Needs:

- CE certification
- Explosion-proof
- Wands
- Threaded end connectors
- Particle counters
- Hydraulic hoses
- Viton® gaskets
- High viscosity push bottom sample valves

The Specs

By the Numbers

Item No.	Description	Qty.
1	Motor	1
2	Gear Pump	1
3	Filter Head	2
4	Pressure Gauge	2
5	Filter Stage 1	1
6	Filter Stage 2	1
7	50" Cord or Cord Reel	1
8	12' Suction Hose	1
9	2' Pressure Hose	1
10	Pump Relief-65psi	1
11	Filter Change Indicator	1

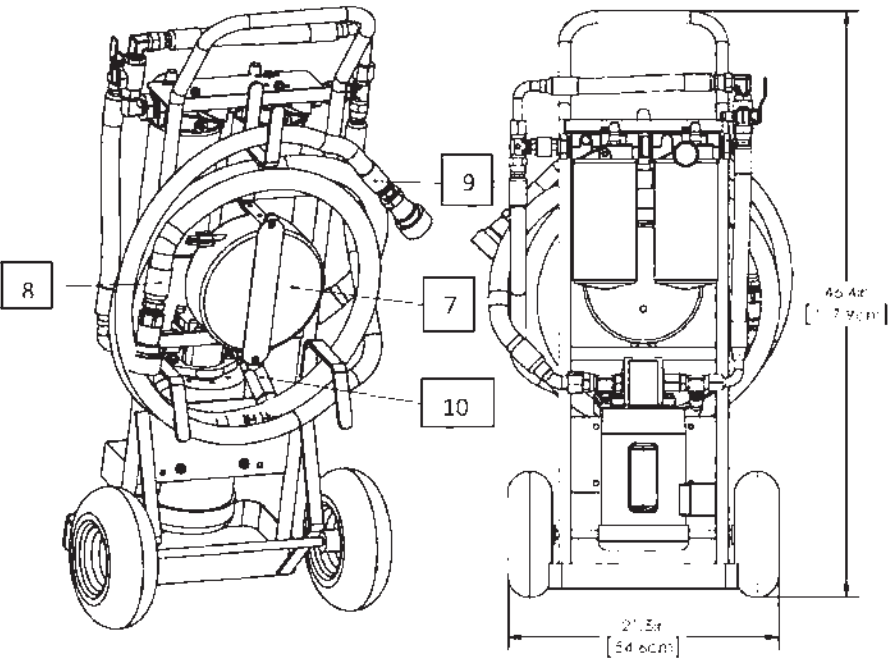
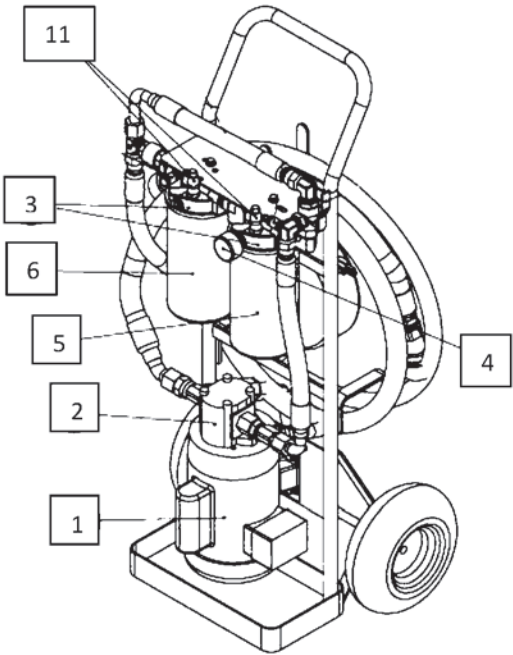

Our standard motors are 115/230 VAC, single phase, 60 Hz

Don't see the options you need? Contact our Technical Support team at (757) 327-6036 or info@chasefiltercompany.com

For ordering information, please see insert or contact us at (757) 327-6036.