

Trouble Shooting

- **Will Not Start**

Check the power switch and power cord connection.

- **No Inlet Flow**

Check system Fluid level and suction hose connection to reservoir.

Check for suction leaks.

- **No Outlet Flow**

Check pressure gauges for above normal pressure. Cause may be dirty filters.

Check for inlet flow.

Wait 10-15 seconds for filters to fill.

- **Intermittent Oil Flow and Aeration:**

Check the system fluid level. Check suction line for leaks.

- **Leaking between the head gasket and the top cap:**

Tighten the Filter to the head.

Still Leaking – Order Gasket 17E-AD-GASKET and replace

- **Leaking between the top cap and the body**

Tighten the filter body to the top cap.

Still Leaking – Order “O” RING 4010-245V7 and replace.

- **Leaking between the body and the bottom cap.**

Order bottom assembly CFB-15035-ASSY-LE and replace.

- **Drain plug leaking**

Wrap with Teflon plumbers tape and re-install.

Still Leaking – If cross threaded, Order bottom assembly CFB-15035-ASSY-LE

Chase Filter Panel

Example Part Number

				A	B	C	D	E					
				CFP	10	-	10MA	-	3M	V	-	N	N
Description				Code									
Section A													
Filter Series	Filter Panel			CFP	CFP								
Section B													
Pump / Motor	10GPM / 1hp electric, 115 vac, 60 hz, 1725 rpms, 13 amps			10	10								
Section C				Material	Micron/Nom	Micron/Abs							
Inlet Element	Cellulose	3		3C	3C								
	Microglass			3M	3M								
	Cellulose	10		10C	10C								
	Cellulose Water Abs.	10		10CA	10CA								
	Microglass	10		10M	10M								
	Microglass Water Absorbing	10		10MA	10MA								
	Cellulose	25		25C	25C								
	Microglass	25		25M	25M								
	SS Mesh	40		100S	100S								
	Section D				Material	Micron/Nom	Micron/Abs						
Outlet Element	Cellulose	3		3C	3C								
	Microglass			3M	3M								
	Cellulose	10		10C	10C								
	Cellulose Water Abs.	10		10CA	10CA								
	Microglass	10		10M	10M								
	Microglass Water Absorbing	10		10MA	10MA								
	Cellulose	25		25C	25C								
	Microglass	25		25M	25M								
	SS Mesh	40		100S	100S								
	Section E				Material								
O-Ring	Buna				N				N				
Material	Viton				V				V				
	EPR				E				E				
Section F				Bypass									
Manual Bypass	Bypass				B				B				
	No Bypass				N				N				
Section G				Ports									
Sample Ports	Standard				S				S				
	None				N				N				



FLUID HANDLING | Panel Unit



A permanently mounted, continuous-duty system for critical applications or difficult to access equipment. It also can serve as a maintenance station.

Don't see the options you need? Contact our Technical Support team at (757) 327-6036 or info@chasefiltercompany.com

307 E. Street, Hampton, VA 23661 | (PH) 757-327-0036 | (F) 757-327-0552
www.chasefiltercompany.com | info@chasefiltercompany.com

The Overview

THE PANEL UNIT

Where It's Used

- Decontaminating systems
- Cooling systems
- Collecting oil samples for analysis

WHAT IS STANDARD?

- Automatic pressure relief valve
- Dual-stage filtration
- Durable frame with drop pan for direct mounting
- Industrial powder-coated paint
- One-year warranty

WHAT CAN I CUSTOMIZE?

- Flow rates
- Filter bypass
- Sample valves
- Oil cooler
- Temperature gauge
- Color
- Hose-end connection sizes and types
- Micron rating of filters

Call CHASE for the Following Needs:

- Explosion-proof
- Particle counter
- Hydraulic Plumbing hoses
- Viton® gaskets
- High viscosity push button sample valves

PERFORMANCE

For filtering mineral-based industrial oils and most synthetic oils with a maximum operating viscosity range of ISO VG 680 (3000ssu/648cSt) at 100°F/38°C within ambient temperature ranges of -15°F to 150°F (-26C to 66°C)

Materials

- Frame: Carbon steel
- Paint: Industrial powder coat
- Filter Heads: Aluminum
- Fittings: Zinc-plated steel and/or brass
- Pumps: Aluminum/steel
- Plumbing Hoses: Clear PVC with steel wire
- Gaskets: Buna-N

Filter Indicators:

- Filter indicator pops at 22psid (1.55bar) as warning that filter elements need to be replaced

Pump Relief:

- Opens at 65psi (5.49bar)

Weight:

- Approximately 100-130 lbs (will vary depending on options selected)

Dimensions:

- 15.6”L x 23.4W x 25.8”H

Did You Know?

New oil isn't clean. One of the best places to start any improvement is in the lube room. While it may not have the biggest effect on the quality of the lubricant in each machine, it helps to set the tone for the whole lubrication program, changing the way mechanics, lubricators and operators think about lubrication.

The Specs

By the Numbers

Item No.	Description	Qty.
1	Motor	1
2	Gear Pump	1
3	Pump Relief-65psi	1
4	Filter Element	2
5	Pressure Gauge	1
6	N/A	-
7	Pre-Filter Sample Valve	1
8	Post-Filter Sample Valve	1
9	Filter Head	2
10	Manual Filter Bypass Valve	1
11	3/4" JIC Inlet Port	1
12	N/A	-
13	Filter Bypass	1
14	Outlet Port location	1

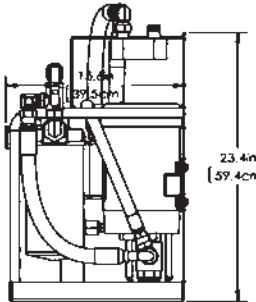
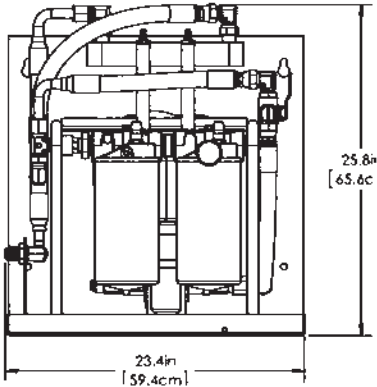
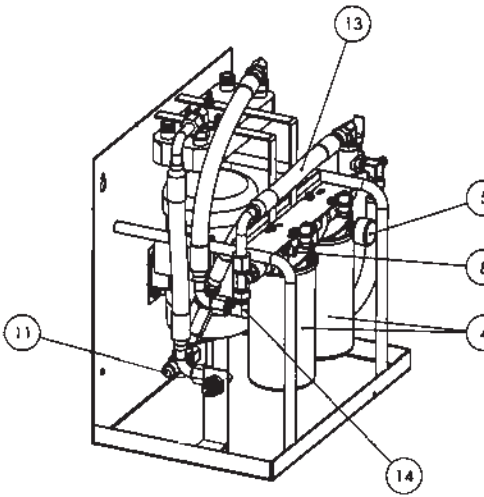
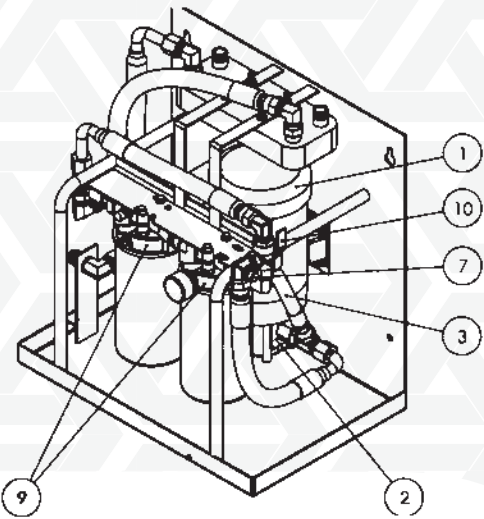

Our standard motors are 115/230 VAC, single phase, 60 Hz.

Don't see the options you need? Contact our Technical Support team at (757) 327-6036 or info@chasefiltercompany.com

For ordering information, please see insert or contact us at (757) 327-6036.