

# 25 SERIES BRASS INLINE FILTER



**NEW: FLUTED SINTERED  
10 MICRON REPLACEABLE ELEMENT**



- INCREASED SURFACE AREA
- INCREASED DIRT HOLDING CAPACITY
- INCREASED FLOW

Patent No: US 8,241,386 B2

**FLOW CAPABILITY:  
CV-0.7**

**COMPACT SIZE:  
2.2" X 1.3"**

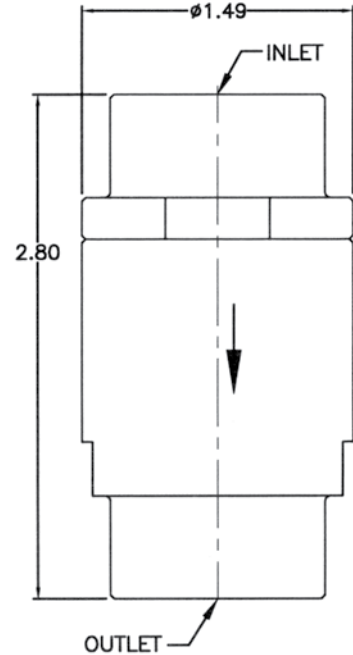

**RATED OPERATING  
PRESSURE:  
5000 PSIG  
OXYGEN**

**MANY PORTING  
OPTIONS  
AVAILABLE**

**SAFE, RELIABLE  
SIDE-SEAL DESIGN**

**DESIGN HAS SUCCESSFULLY PASSED MODIFIED ASTM G175 PHASE 2 PROMOTED  
IGNITION TEST WITH 5000 PSIG OXYGEN**

